

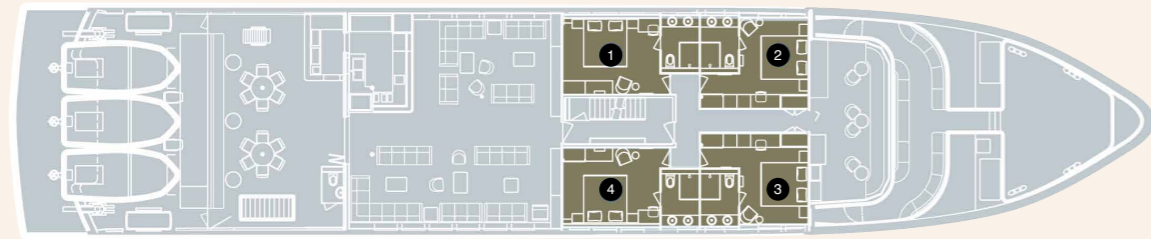

ABOARD THE TRUE NORTH

STATEROOM:
EXPLORER CLASS



LOCATION:
UPPER DECK

Located on the upper deck, Explorer Class staterooms feature a king size bed (that can be converted to singles) and a twin basin en-suite. Cabin size is 18 square metres (193 square feet). Other features include large panoramic windows, amenities fridge, in-cabin entertainment and satellite telephone.

**EXPLORER CLASS
STATEROOMS:**

1. Bradshaw
2. Dampier
3. Durack
4. Parker King

FEATURES:

- Approximate dimensions 3m x 4m (Ensuite 2m x 1.75m)
- King size beds (can be split into singles if requested)
- Large panoramic windows
- Spacious ensuite featuring twin basins and panoramic windows
- Original artwork in the cabin
- Plenty of storage for clothing and other personal items
- Amenities fridge
- Writing desk and chair
- Flatscreen TV and onboard entertainment system
- Air conditioning
- Satellite phone



STATEROOM:
RIVER CLASS

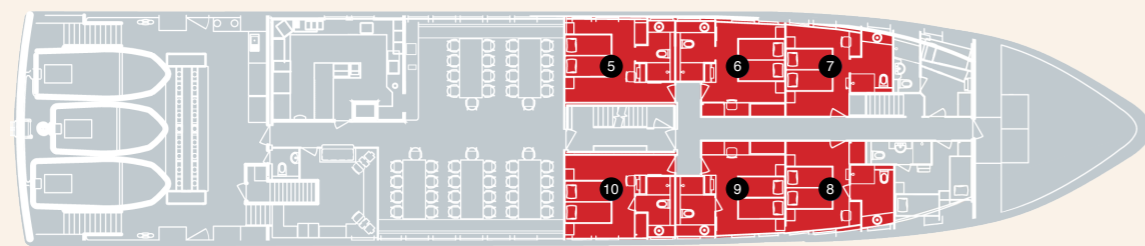

LOCATION:
MAIN DECK

Located on the main deck, River Class staterooms feature a king size bed (that can be converted to singles) and en-suite. Cabin size is similar to Explorer Class. Other features include large panoramic windows, in-cabin entertainment and satellite telephone.

**RIVER CLASS
STATEROOMS:**

- 5. Prince Regent River
- 6. Mitchell River
- 7. Berkeley River
- 8. Drysdale River
- 9. Hunter River
- 10. King George River

FEATURES:

- Approximate dimensions 3.5m x 3.5m (Ensuite 2m x 1.75m)
- King size bed (can be split into singles if requested)
- Spacious ensuite with panoramic windows
- Large panoramic windows
- Plenty of storage for clothing and other personal items
- Flatscreen TV and onboard entertainment system
- Air conditioning
- Satellite phone

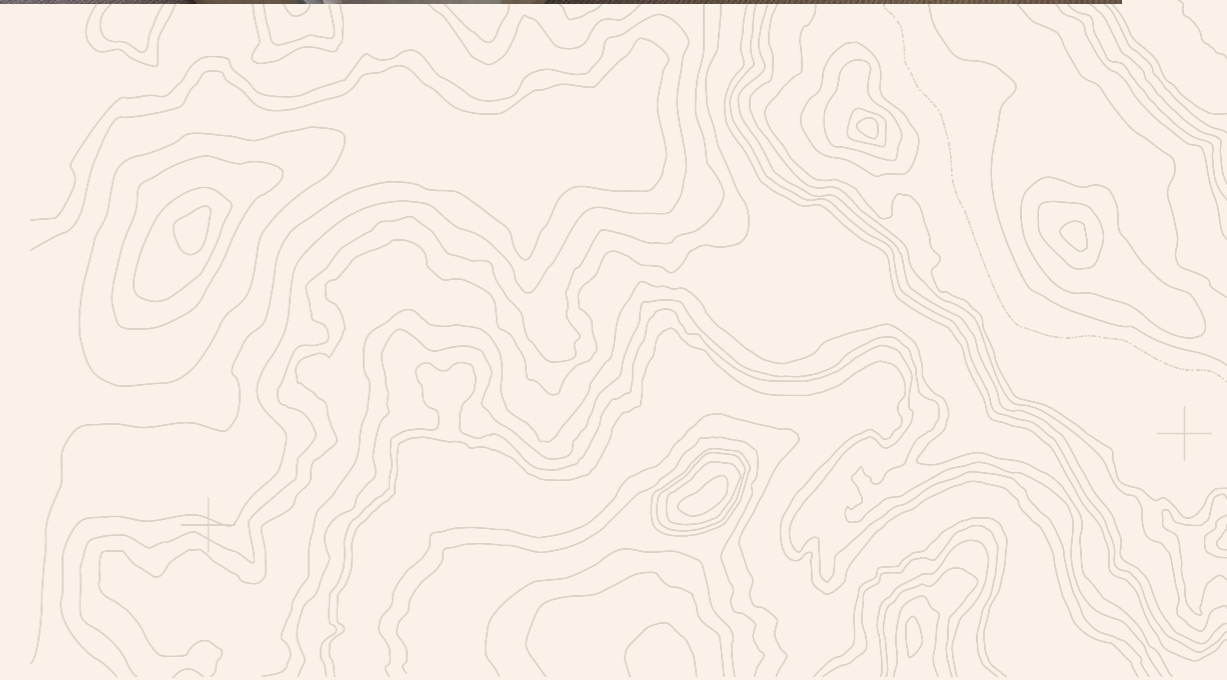

CABIN:

OCEAN PREMIUM



LOCATION:

LOWER DECK

Located on the lower deck, Ocean Premium doubles feature a king size bed (that can be converted to singles) and en-suite. Cabin size is approximately 14 square metres (150 square feet). Other features include 2 portholes, in-cabin entertainment and satellite telephone.

OCEAN PREMIUM
CABINS:

[13. Koolama Bay](#)

[18. Atlantis Bay](#)

FEATURES:

- Approximate dimensions 3.5m x 3m (Ensuite 1.5m x 1.75m)
- King size bed (can be split into singles if requested)
- Spacious ensuite
- Large portholes allow plenty of natural light
- Plenty of storage for clothing and other personal items
- Flatscreen TV and onboard entertainment system
- Air conditioning
- Satellite phone



CABIN:

OCEAN CLASS



LOCATION:

MAIN & LOWER DECK

Located on the lower deck, Ocean Class twins feature roomy singles and en-suite. Cabin size is approximately 12 square metres (129 square feet). Other features include 2 portholes, in-cabin entertainment and satellite telephone.

OCEAN CLASS CABINS:

MAIN DECK

- 11. Camden Harbour
- 12. Lacepede Islands

LOWER DECK

- 14. Montgomery Reef
- 15. Jackson Falls
- 16. King Cascade
- 17. Imperieuse Reef

FEATURES:

- Approximate dimensions 2.5 to 3m x 3m (Ensuite 1.5m x 1.75m)
- Roomy twin configured single beds
- Spacious ensuite
- Large portholes allow plenty of natural light
- Drawers and closet space to store clothing and other personal items
- Flatscreen TV and onboard entertainment system
- Air conditioning
- Satellite phone



Vessel
TRUE NORTH

Ship specifications

Commissioned	February 2005
Flag	Australian
Refit	Annually
Configuration	Mono-hull adventure cruise ship
Length	50 metres
Tonnage	740 tonnes
Draught	2.2 metres
Beam	10 metres
Crew	22
Passengers	36
Cruising Speed	14 knots
Bow Thruster	100 kW
Propulsion	2 x 786 kW
Auxiliary	2 x 175 kW
Range	2,000 miles
Water Making Capacity	1,500 lts per hour
Motion Control	Computer controlled stabilizers
Safety	Full compliance under AMSA and IMO standard
Fuel	45,000 lts diesel / 10,000 lts Jet A 1/3,000 lts ULP
Cabin Features	En-suite, in-cabin entertainment and satellite telephone
Cabin Power	240V and 110V (Australian Socket)
Adventure Vessels	6
Helicopter	Eurocopter (6 pax all facing forward/ airconditioned)
Day Areas	Sun deck, observation lounge, ship's lounge, alfresco bar, sport deck and dining room

